



Elm Grove Greasbrough Rotherham S61 4QB

Guide Price £145,000 to £150,000



- **Superb Three Bedroom Mid-Town House**
- **Well-Maintained Throughout**
- **Beautiful Kitchen Diner in a gloss cream finish with Integral Cooking Appliances**
- **Ideal First Time or Investment Purchase**
- **Popular Residential Location close to Schools, Shops and Transport Links**
- **Spacious Lounge Reception, Handy Downstairs WC**
- **Three Ample Bedrooms and a Stylish Wet / Shower Room**
- **** Viewing Advised ****

Guide Price £145,000 to £150,000 - This three bedroom mid-town house is located within the popular residential area of Greasbrough a well-established village and suburb of Rotherham, located approximately 2 miles (3 km) north of Rotherham town centre with easy access transport links, shops, schools and recreational spaces like Greasbrough Park offer green space, play areas, bowling greens and community facilities.

It is well-maintained and beautifully appointed throughout with ground floor internal accommodation comprising of a spacious Lounge Reception, a perfect place to relax, a generous Kitchen Diner, the Kitchen appointed with a smart modern range of wall and base units in a cream gloss finish with complimentary work tops and with integrated cooking appliances. There is also the convenience of a downstairs WC.

The first floor has three ample sized bedrooms, two doubles with built-in wardrobes, one single, and there is a stylish fully wall lined Wet Room / Shower Room.

Externally, it comes with enclosed low maintenance Courtyards to both the front and rear, the rear with a pleasant field side back drop.

This super home will be of broad appeal from first timers, to families alike and may also appeal to buy-to-let investors with demand rental for this location high. As for details of our fully managed lettings service.

VIEWING ADVISED - APPOINTMENT ONLY.





GROUND FLOOR
451 sq. ft. (41.9 sq.m.) approx.

1ST FLOOR
450 sq. ft. (41.8 sq.m.) approx.

DynamicsPDF, Rasterizer v2.0 evaluation: www.DynamicsPDF.com

[Find an energy certificate \(/\)](#)

English | [Cymraeg](#)

Energy performance certificate (EPC)

19 Elm Grove ROTHERHAM S61 4GB	Energy rating C	Valid until: 20 October 2031
	Certificate number:  1905-3200-3689-0200	

Property type: Mid-terrace house

Total floor area: 86 square metres

Rules on letting this property

Properties can be let if they have an energy rating from A to E.

You can read [guidance for landlords on the regulations and exemptions](https://www.gov.uk/guidance/domestic-private-rented-property-minimum-energy-efficiency-standard-landlord-guidance) (<https://www.gov.uk/guidance/domestic-private-rented-property-minimum-energy-efficiency-standard-landlord-guidance>).

Energy rating and score

This property's energy rating is C. It has the potential to be B.

[See how to improve this property's energy efficiency.](#)

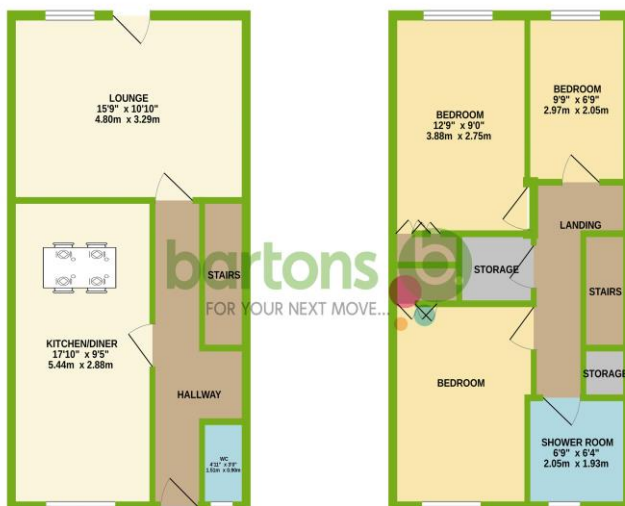

TOTAL FLOOR AREA: 901 sq. ft. (83.7 sq.m.) approx.

While every attempt has been made to ensure the accuracy of the description contained here, measurements of floor, wall, ceiling and any other items are approximate and no responsibility is taken for any error, omission or mis-statement. This plan is for illustrative purposes only and should be used as such by any prospective purchaser. The services, fixtures and appliances shown here are not intended to be guaranteed as to their quantity or efficiency can be given. Made with HomeOS 12/23



FREE Property Valuation & Appraisal We offer a FREE of charge property valuation service. Call us now to book your appointment and to find out why we are the agent of choice when selling your home. Our fees are flexible and the service is second to none. Please feel free to visit our website at: www.bartons-net.co.uk

Energy Performance Certificate (EPC) If you are selling a property you will need an Energy Performance Certificate. It contains information on your home's energy use and carbon dioxide emissions. It also contains a recommendation report with suggestions to reduce energy use and carbon dioxide emissions. EPCs carry ratings that compare the current energy efficiency and carbon dioxide emissions with potential figures that the property could achieve. Potential figures are calculated by estimating what they might be if certain energy saving matters were to be put in place. The rating measures the energy and carbon dioxide emission efficiency of a property, using a grade from 'A' down to 'G'. An 'A' rating is the most efficient, whilst 'G' is the least efficient.

Mortgage Services - Make it a great move with a GR8 Mortgage.



Finding the right mortgage needn't be stressful. Bartons have in-house, totally impartial, mortgage advisers who are available to help you find a mortgage that's just right for you. Appointments for general advice are free of charge and available in and out of office hours - call on 01709 515740.

How to make an Offer

If you are interested in this property then it is important that you contact us at your earliest convenience. Failure to do so can result in unnecessary costs and may ultimately lead to you losing out on the property.

For any offer you wish to make we will need to establish certain details before negotiation can take place. This is so that our vendor can make an informed choice when negotiating and accepting your offer. You will be asked to make an early appointment so that we can suitably qualify your position and ability to proceed.

You will be asked to provide formal I.D. and address verification, as required under new Anti-Money Laundering Legislation. You might also have one or two questions for us, such as which solicitor to choose, or which mortgage lender has the best offers available for me. We have a one stop shop to satisfy all of these needs so please ask.

We routinely offer to assist both potential buyers and sellers by referring them to local and regional conveyancing firms to aid with the legal work in respect of a sale and / or purchase. It is your decision whether you choose to deal with them. However, you should be aware that if you choose to adopt their services we may receive a fee of up to £135 plus VAT for recommending them.

These particulars are issued in good faith but do not constitute representations of fact or form part of any contract. The particulars should be independently verified by prospective buyers or tenants. Neither Barton Real Estates Ltd nor any of its employees or agents has any authority to make or give any representation or warranty whatever in relation to this property.

GENERAL: While we endeavour to make our sales particulars fair, accurate and reliable, they are only a general guide to the property and, accordingly, if there is any point which is of particular importance to you, please contact the office and we will be pleased to check the position for you, especially if you are contemplating travelling some distance to view the property. **SERVICES:** Please note that we have not tested the services or any of the equipment or appliances in this property, accordingly we strongly advise prospective buyers to commission their own survey or service reports before finalising their offer to purchase. **TENURE & PLANNING PERMISSION:** We have not verified the tenure or any planning permission and you and your professional adviser must satisfy yourselves of the tenure and check any planning permissions or building regulations. Any comments about planning and development are for general guide only and your professional adviser must advise you. We cannot give any warranty about development potential. **PHOTOGRAPHY:** In order to obtain the most accurate representation of the property we can use cameras with zoom and telephoto features, this may result in wide-angle shots in some instances. Additionally, the exterior photograph(s) may have been taken from a vantage point other than the front street level. **UNOCCUPIED PROPERTIES:** If the property is unoccupied and the services to it no longer connected we will not have been able to check their condition. Accordingly, we strongly advise prospective buyers to commission their own survey before offering. **VIEWING:** Through the Agents who will be pleased to arrange a mutually convenient time to view the property on 01709 515740.

**** CARE - Buyers should also seek further clarification regarding broadband connections, speeds, mobile phone signal and coverage, risk of floods, risks associated with coalfield or coal mining and details of any local planning applications which may affect your decision to purchase this property. Useful links are available via our website www.bartons-net.co.uk/links**